

Keysight 11636B APC-3.5 mm Power Divider DC to 26.5 GHz

11636B Power Divider

Introduction

From DC to 26.5 GHz, the 11636B provides excellent output power symmetry between the two output ports. Its design provides excellent source match for fault applications using network analyzers. However, it is not recommended for ratio or source leveling applications.

The 11636B provides a symmetrical 6 dB power division. It can also be used as a power combiner: when signals are input at the two output ports, the sum of the two signals appears at the input port.

Specifications

Maximum Input Power: 0.5 W (27 dBm)

Frequency Range: DC to 26.5 GHz

Input/Output SWR:

- DC to 10.0 GHz: ≤ 1.22
- 10.0 GHz to 26.5 GHz: ≤ 1.29

Tracking Between Output Ports:

- DC to 18.0 GHz: < 0.25 dB
- 18.0 to 26.5 GHz: < 0.50 dB

Maximum Insertion Loss: < 7.5 dB (DC to 26.5 GHz)

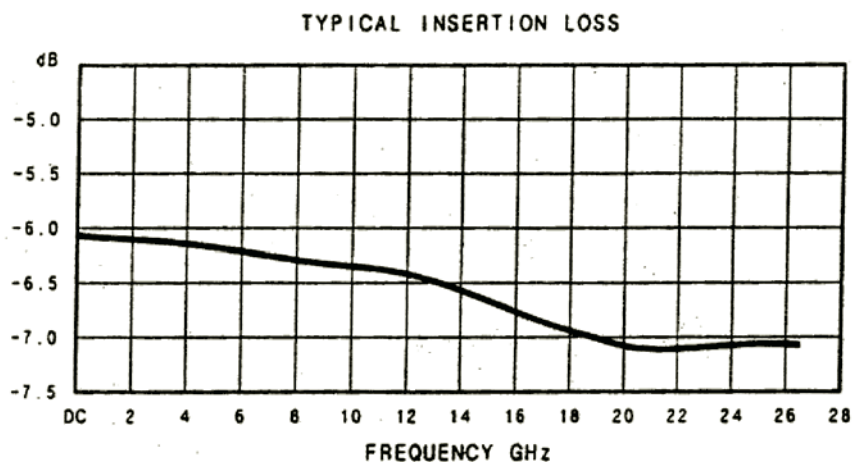

11636_001_1

Phase Tracking Between Output Arms: < 3 degrees, Typical

Nominal Insertion Loss: 6.0 dB + 0.04 dB/GHz

Number of Ports: Three

Connectors: 3.5 mm on all ports

Dimensions:

NOTE In the following graphic, dimensions are given in inches (cm) and are maximum unless otherwise specified.

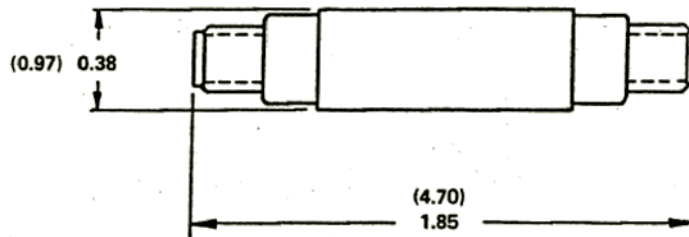
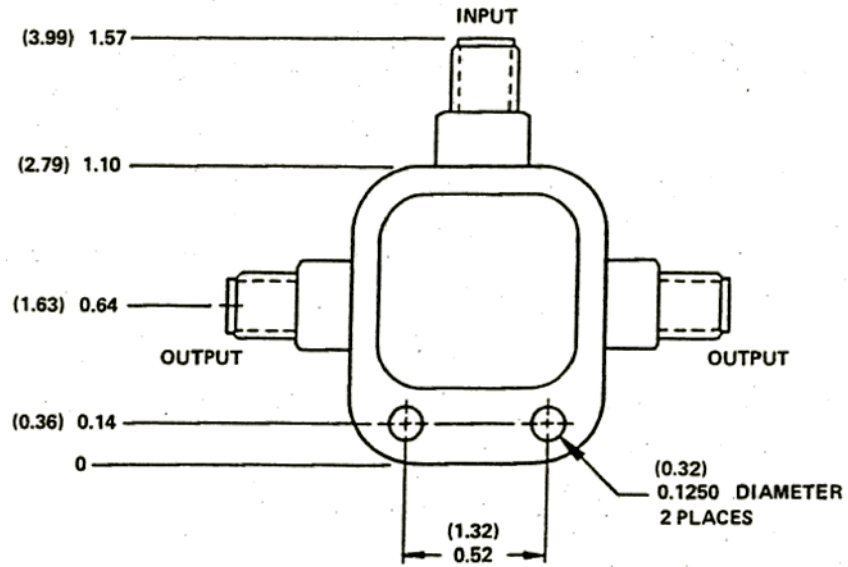

11636_001_2